

CENTRAL PENINSULA SCHOOL TASK FORCE

Purpose:

To develop an innovative vision for the proposed new Central Peninsula School as a community hub, providing vital programs and services to residents experiencing low-incomes, and as a centre for excellence for innovative forms of teaching and learning.

The Task Force was launched as a visioning and analysis exercise to prepare a cohesive strategy for the development of an innovative school model and build a business case for why priority neighbourhood schools are unique in both the challenges faced and the return-on-investment in thoughtful educational infrastructure. A broad cross-section of community, municipal and provincial stakeholders engaged responded positively to the vision and are hopeful that momentum to continue to support the project is maintained. GNB announced in 2021 that land acquisition for this project is in the 2022/23 Budget and we await confirmation of the Task Force's recommendations.

Central Peninsula School Conceptual Design

Building Footprint

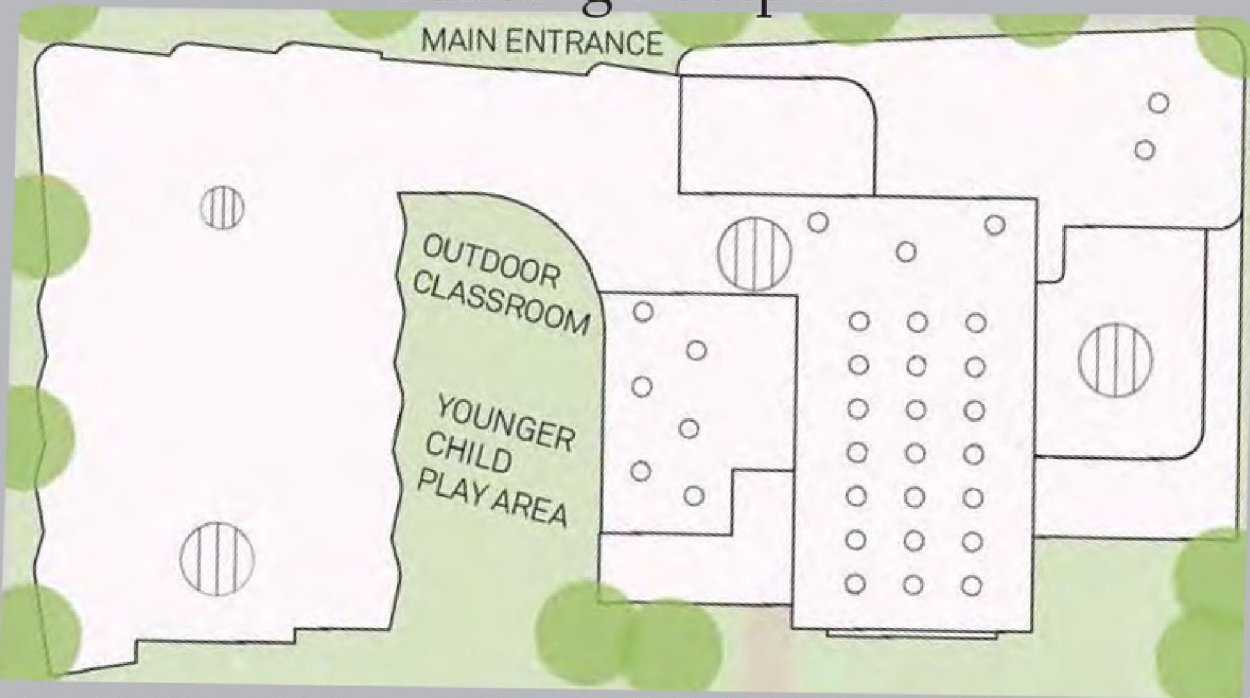

Rear Site Aerial Rendering



First Floor

Daytime community programming entrance with shared access to community kitchen and access to additional community programming rooms upstairs. Direct connection to Gym, multi-purpose room & community commons when School is not in session.

Early Learning Centre Wing, with ability for access control.

Community Commons



Second Floor



Upper floor community programming rooms. Two 800 sq. ft. rooms with operable wall for combining the rooms into a larger 1,600 square foot space.



Collaborative, central project spaces with visual connections to classrooms.

Third Floor



\$85,000

SOCIAL INNOVATION FUNDING

1 year / 2 phases

complete